

## EASY WATERING TIMER

*"Clicker"*

With just 1 button

## FEATURE:

- Easy timing with just one button.
- 12 predefined irrigation programs to meet any typical requirement of any dripping system.
- LED Indicator of the running program.
- Low battery indicator.
- "Delay" function, activated with 3 secs press on the button.
- Sealed compartment for the batteries.
- Works with 2 AAA batteries 1,5 volt.
- Internal mechanising with membrane.
- Minimum working pressure: 1 Bar.
- Detachable front panel.
- Metallic mesh and 2 threads included for 1/2" & 3/4" faucets.
- With a universal adaptor on the exit.

2 years  
WARRANTY

**EXTERIOR DIAL SHOWS IRRIGATION DURATION (in minutes)**  
**INTERIOR DIAL SHOWS IRRIGATION FREQUENCY (in hours)**

FOR THE IRRIGATION SYSTEM SAFETY, PLEASE USE A PRESSURE  
 REGULATOR (not included)

## Battery Installation:

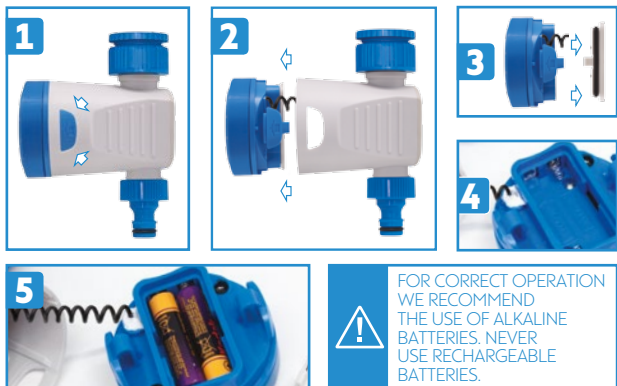

## When placing the batteries on the compartment:

Valve is closed. All LEDs blink once. OFF LED stays on for a minute.



## When pressing the button:

Every time you press the button, the LED light will change its position.



The valve will open after 4 seconds.

## When in regular operation:

All LED lights will stay OFF.

## When pressing central button once:

The timer will show what the selected settings are.

## When low battery:

That valve will close for safety. The button will not work. All 14 LED lights will be blinking in order every second as a warning notice.

## Delay Function: Press the button for 3 seconds to activate it:

All LED lights will be ON. Every press will mean 1 hour delay for irrigation. In the case you do not want to use this function once activated, just wait for 5 seconds to go back to regular settings.



## Example of how Day function works.

To irrigate for 10 min. every 48 hours (at 8 pm).

It is 6 in the afternoon. Place the batteries on the compartment. Press the button once. LED light will show the current irrigation schedule. Place the LED light on the desired schedule pressing the button. The valve will open after 4 secs. Press the button for 3 secs. The valve will close, all 14 LEDs will light (Delay Activated). Press the button twice to delay the irrigation time 2 hours.



The timer will open at 8 at night for 10 minutes and will keep on going like that every 24 hours.