

ELENCO PEZZI DI RICAMBIO  
 LISTE PIECES DETACHEES  
 SPARE PARTS LIST  
 ERSATZTEILLISTE  
 PIEZAS DE REPUESTO

## D-ARC 200

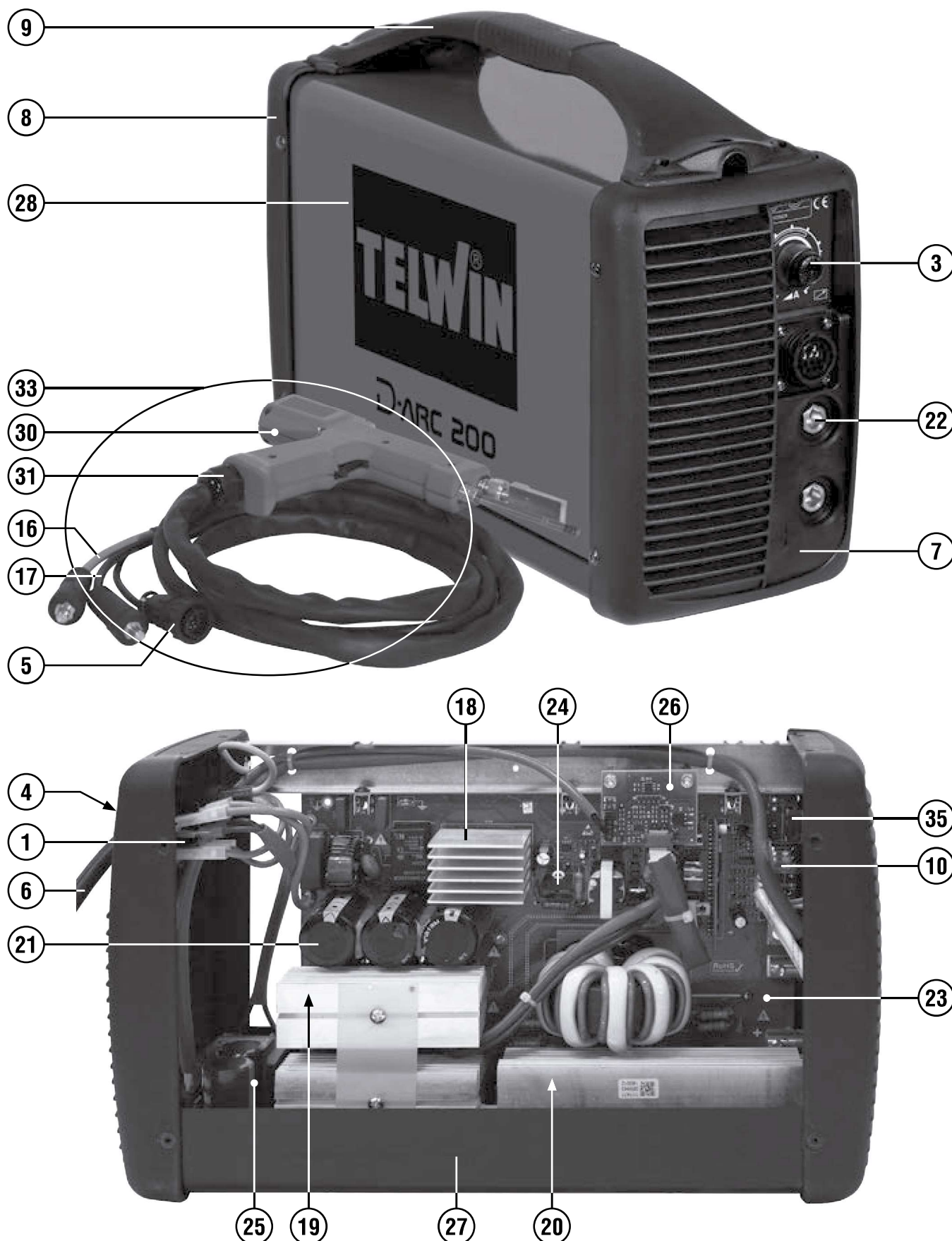

Esploso macchina, Dessin appareil, Machine drawing, Explosions Zeichnung des Geräts, Diseño seccionado maquina.



| REF. | ELENCO PEZZI DI RICAMBIO<br>PIECES DETACHEES<br>SPARE PARTS LIST<br>ERSATZTEILLISTE<br>PIEZAS DE REPUESTO | CODICE<br>CODE<br>KODE |
|------|---|------------------------|
| 1    | Interruttore<br>Interrupteur<br>Switch<br>Schalter<br>Interruptor   | 121248                 |
| 2    | Microinterruttore<br>Microinterrupteur<br>Microswitch<br>Microschalter<br>Microinterruptor                | 121329                 |
| 3    | Manopola<br>Poigne<br>Knob<br>Griff<br>Manija   | 121394                 |
| 4    | Copri interruttore<br>Couvre interrupteur<br>Switch cover<br>Schalterdeckel<br>Cubre interruptor          | 122353                 |
| 5    | Cablaggio pistola<br>Cable pistolet<br>Gun cable<br>Kabel für pistole<br>Cable pistola                    | 125204                 |
| 6    | Cavo alimentazione<br>Cable de reseau<br>Mains cable<br>Netzabel<br>Cable de alimentation                 | 132157                 |
| 7    | Frontale<br>Partie frontal<br>Front panel<br>Gerätefront<br>Frontal                                       | 321355                 |
| 8    | Retro<br>Partie arriere<br>Back panel<br>Rueckseite<br>Trasera  | 322694                 |
| 9    | Manico<br>Poignee<br>Handle<br>Handgriff<br>Manija  | 322695                 |
| 10   | Guida luce<br>Guide<br>Guide<br>Führung<br>Guia   | 322898                 |
| 11   | Portaelettrodo<br>Porte electrode<br>Electrode holder<br>Elektrodenhalter<br>Portaelectrodo               | 433189                 |
| 12   | Mandrino<br>Mandrin<br>Mandrel<br>Dorn<br>Mandril   | 433190                 |

| REF. | ELENCO PEZZI DI RICAMBIO<br>PIECES DETACHEES<br>SPARE PARTS LIST<br>ERSATZTEILLISTE<br>PIEZAS DE REPUESTO   | CODICE<br>CODE<br>KODE |
|------|---|------------------------|
| 13   | Ghiera per elettrodo<br>Collier de serrage electrode<br>Electrode locking<br>Nutmutter für elektrode<br>Anillo de bloqueo electrodo   | 433191                 |
| 14   | Ghiera per mandrino<br>Embout pour mandrin<br>Nut for mandrel<br>Nutmutter für dorn<br>Anillo para mandril  | 433193                 |
| 15   | Elettrodo<br>Electrode<br>Electrode<br>Elektrode<br>Eletrodo  | 690213                 |
| 16   | Cavo tw05v-f 1x010 l=03,00m-ax25+occh.<br>Cable tw05v-f 1x010 l=03,00m-ax25+oeil.<br>Cable tw05v-f 1x010 l=03,00m ax25+eyel.<br>Kabel tw05v-f 1x010 l=03,00m-ax25q+öse<br>Cable tw05v-f 1x010 l=03,00m-ax25+ojete | 713309                 |
| 17   | Cavo tw05v-f 1x010 l=03,00m-ax25+occh.<br>Cable tw05v-f 1x010 l=03,00m-ax25+oeil.<br>Cable tw05v-f 1x010 l=03,00m-ax25+eyel.<br>Kabel tw05v-f 1x010 l=03,00m-ax25+öse<br>Cable tw05v-f 1x010 l=03,00m-ax25+ojete  | 713310                 |
| 18   | Kit ponte monofase<br>Kit pont monophasé<br>Single phase bridge kit<br>Einfasige brücke kit<br>Kit puente monofasico  | 981581                 |
| 19   | Kit igbt + diodi<br>Kit igbt + diodes<br>Kit igbt + diodes<br>Kit igbt + dioden<br>Kit igbt + diodos  | 981582                 |
| 20   | Kit diodi<br>Kit diodes<br>Diode kit<br>Diode kit<br>Kit diodo  | 981583                 |
| 21   | Kit condensatore snap-in<br>Kit condensateur snap-in<br>Condenser kit snap-in<br>Kondensator kit snap-in<br>Kit condensor snap-in   | 981584                 |
| 22   | Kit prese atlas 25mmq<br>Kit prises atlas25mmq<br>Atlas sockets kit 25mmq<br>Atlas steckdose kit 25mmq<br>Kit enchufes atlas 25mmq  | 981587                 |
| 23   | Kit scheda potenza<br>Kit carte puissance<br>Power board kit<br>Leistungskarte kit<br>Kit tarjeta potencia  | 982124                 |
| 24   | Kit mosfet flyback<br>Kit mosfet flyback<br>Mosfet flyback kit<br>Mosfet flyback kit<br>Kit mosfet flyback  | 981585                 |

| REF. | ELENCO PEZZI DI RICAMBIO<br>PIECES DETACHEES<br>SPARE PARTS LIST<br>ERSATZTEILLISTE<br>PIEZAS DE REPUESTO  | CODICE<br>CODE<br>KODE |
|------|--|------------------------|
| 25   | Kit scheda ausiliario<br>Kit platine auxiliare<br>Auxiliary board kit<br>Hilfskartekit<br>Kit tarjeta auxiliaria   | 982175                 |
| 26   | Kit scheda plug-in<br>Kit module plug-in<br>Pcb kit plug-in<br>Steuerungskit plug-in<br>Kit tarjeta plug-in  | 982176                 |
| 27   | Kit fondo<br>Kit chassis<br>Bottom kit<br>Bodenteil kit<br>Kit fondo   | 982177                 |
| 28   | Kit mantello<br>Kit capot<br>Cover kit<br>Deckel kit<br>Kit panel de cobertura   | 982178                 |
| 29   | Kit portarondella<br>Kit support rondelle<br>Washer holder kit<br>Scheibehalterung kit<br>Kit sosten arandela  | 982179                 |
| 30   | Kit impugnatura<br>Kit poignee<br>Handle kit<br>Handgriff kit<br>Kit empunadura  | 982180                 |
| 31   | Kit pressacavo + ghiera<br>Kit presse cable + embout<br>Kit cable bushing + ring nut<br>Kit kabelhalter + nutmutter<br>Kit prensa cable + virola             | 982181                 |
| 32   | Kit elettromagnete<br>Kit electroaimant<br>Electromagnet kit<br>Elektromagnet kit<br>Kit electroimán   | 982182                 |
| 33   | Pistola d-arc<br>Pistolet d-arc<br>D-arc gun<br>D-arc pistole<br>Pistola d-arc   | 804132                 |
| 34   | Portaelettrodo<br>Porte electrode<br>Electrode holder<br>Elektrodenhalter<br>Portaelectrodo  | 433275                 |
| 35   | Pot. Carb. 1k lin. 0.20w 10%<br>Pot. Carb. 1k lin. 0.20w 10%<br>Pot. Carb. 1k lin. 0.20w 10%<br>Pot. Carb. 1k lin. 0.20w 10%<br>Pot. Carb. 1k lin. 0.20w 10% | 111487                 |

Esplso macchina, Dessin appareil, Machine drawing, Explosions Zeichnung des Geräts, Diseño seccionado maquina.

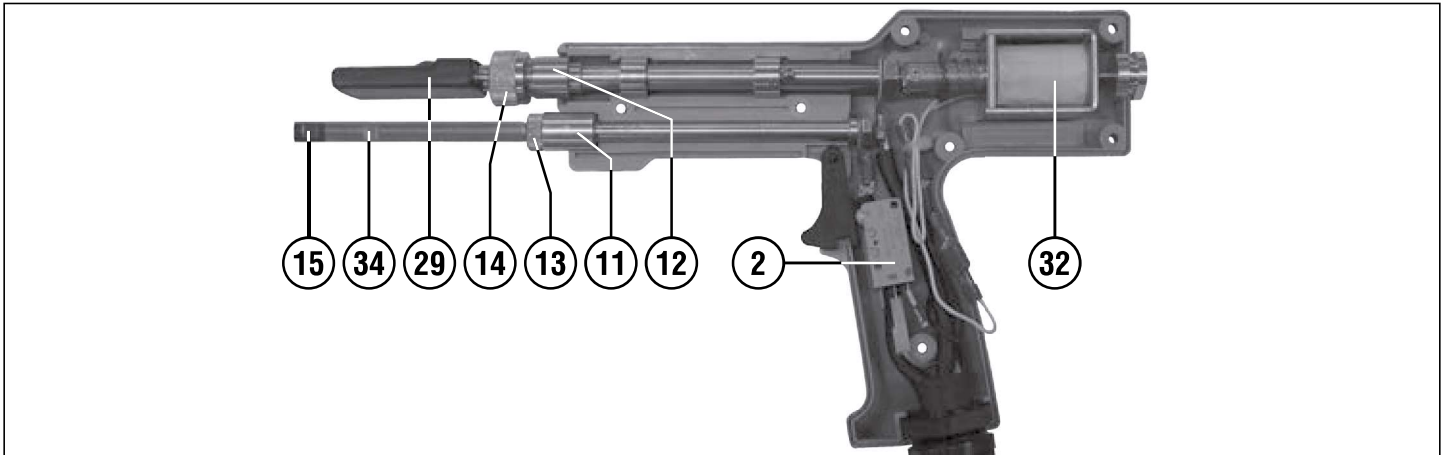

Schema elettrico, Schéma électrique, Diagram, Schaltplan, Esquema de conexiones.

