



ES



EN

LLAVE PARA RÓTULAS AXIALES 5660 WRENCH AXIAL BALL JOINT 5660

Características / Features

Llave para rótulas axiales. / Wrench axial ball joint.

Rápido y eficaz. / Fast and effective.

Puntos clave / Key point:

- Permite reemplazar las rótulas axiales o las barras de dirección sin desmontar el piñón y la cremallera. / It allows the axial ball joint separator replacement without disassembling the rack and pinion.

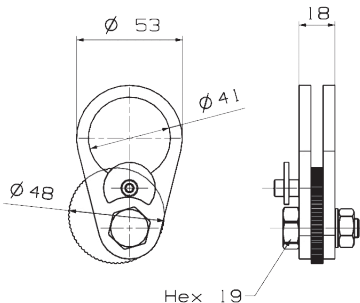
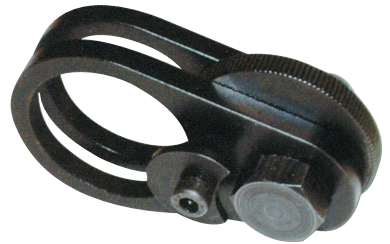

Ref.	Descripción	Peso
5660	Ø INTERIOR DE 33 A 41 MM EN HEXAGONO DE 31 A 36 MM LONGITUD TOTAL 85 MM Ø interior from 33 to 41 mm Hexagon from 31 to 36mm total length 85 mm	0,4

TIPOS DE RÓTULAS / TYPES OF BALLETS

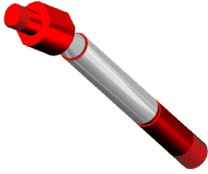

Rotula con 2 planos
Ball joint with 2 planes



Rotula con hexágono
Ball joint with an hexagon



Rotula redonda
Round ball joint

Instrucciones / Instructions

Utilizar con un vaso de 19 y una llave.
Use with a socket spanner of 19 and a wrench

